

# Employment Opportunities

Graduates of the BLA, MTLA and PhD programs, upon obtaining their professional license may pursue the following careers in Landscape Architecture:

- o Design
- o Construction
- o Construction Management\*
- o Project Management\*
- o Landscape Ecologist\*
- o Landscape Conservationist\*
- o Post Construction Services  
( Grounds Maintenance,  
Post Construction Evaluation)
- o Design Review
- o Environmental Consultancies\*
- o Academe ( Teaching, Research )

*\* requires further specialized training and accreditation*

# Landscape Architect



[www.prc.gov.ph](http://www.prc.gov.ph)

The **PROFESSIONALS**



## Landscape Architect

Be the best  
**MAKE A DIFFERENCE**



# Landscape Architect

Defining and enhancing the built environment, Landscape Architects design the environment in a scientific, aesthetic and orderly manner in coordination with all allied services, systems and processes necessary in order to *enhance and safeguard life, health and property, and the promotion and enrichment of the quality of life*

Landscape Architects design the environment with sound ecological basis and considerations to promote the conservation and preservation of natural resources and eco-systems.

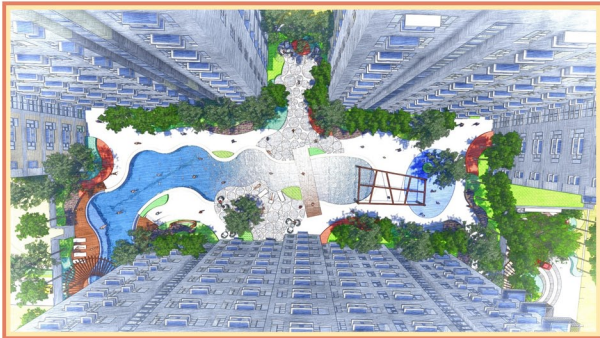

## Skills and Competencies

- Graduate of a CHED accredited higher educational institution in the Bachelor in Landscape Architecture program, Masters in Tropical Landscape Architecture, or Doctoral in Landscape Architecture.
- Must be a registered and licensed Landscape Architect at the Professional Regulation Commission
- Be able to Communicate effectively through verbal and visual methods
- Must have adequate knowledge of local building laws and international building standards
- Must be able to effectively analyze given problems to come up with appropriate solutions
- Must have adequate knowledge of current building materials, methods and technology
- Must be able to sustain a balance between nature and the built environment through proper design
- Must always maintain stewardship of the land as a guiding principle in developing sites
- Must be able to work in teams



## Cost of Education

Educational costs vary from Php 7,000.00 – 29,000.00 for the Baccalaureate degree from State Universities and from Php 40,000.00 – 50,000.00 in private universities per semester.

Masters in Tropical Landscape Architecture (offered only at UP Diliman) will cost Php 2,500.00 per unit plus miscellaneous fees per semester.